



FPF INSTALLATION INSTRUCTIONS

(Installation DVD is included in your accessory box. Please watch before you install.)

****Please read the entire instructions before starting to install.****

NOTE: Sauna room should be installed on a level, waterproof floor (ceramic tile, concrete, vinyl, etc.). If floor is not level, 2 x 4 Base may be cut or shimmed.

Items Required for Installation: Power Screw Driver with #2 Phillips Bit and 3 1/2" long #2 Phillips Extension Bit, Hammer, Level, Saw, Tape Measure

Base

1. Assemble 2 x 4 base with screws provided. A #2 Phillips Head Bit will be required. Push the base into position and be sure that it is level; if it is not level, you can shim or cut the base as necessary.

Wall Panels

2. Before assembly, remove the protective shipping blocks from the bottom and sides of each wall panel. Line up wall sections as per numbers on top left & top right of panels. (L1 matches up to BL1, B1 to B1, B2 to B2, L3 to FL3, etc.). To assemble sections, metal brackets slide into grooves and onto pins. To do this, lift panel up an inch or two and slide into place; then pull down to set into position on the base. Some panels may need to be tapped down into place with a block and hammer.
3. Start at the back left corner (Panels BL1 and L1). Set panel BL1 on the back left side of the base so that the groove at the bottom of the panel straddles the base. Then latch L1 (the first left wall panel) to BL1 (the first back wall panel). Attach the rest of the back wall panels. Then continue with the right and left side wall sections. Set the front left panel (FL) in place.

Door and Last Wall Panel

4. Install the door. Remove the 2 nails from the door jamb that held the door shut for shipping. Next, fasten the handles to the door with the screws provided. When installing the door handles, the handle on the inside of the Sauna should be located close to the glass edge of the door rail. The handles should be offset from each other and centered on the roller catch. Slide the door into position.
5. The last panel will be the front right panel. Pull down the last panel locking it to the corner right wall panel. For 6 x 8, 8 x 8, and 8 x 10 rooms, front wall order of installation is reversed, start with front right and end with front left.
***Install Tip: Certain circumstances at job site may make it more difficult to install the last panel. If necessary, you can unscrew the front right 2 x 4 base, install the last panel, then screw the base back together.*

Door Header

6. Install the door header piece and attach with screws provided. There should be no gaps between the panels.

Ceiling Trim

7. Measure and cut the 1" x 1" molding for the back wall. Install the molding to the wall with the #6 x 2" screws so that the top of the molding is even with the top of the paneling material. Measure, cut, and install the ceiling molding for the left and right walls. Do not install the ceiling trim for the front wall at this time.

Ceiling Panels

8. Move the ceiling panel(s) into place. For rooms with two or more ceiling panels, the front and back panels are marked. Starting with the Back Panel, carefully lift the ceiling panel over the Sauna and place into position. Panel will rest on top of the ceiling trim and interior paneling. To interlock the ceiling panels, push both

panels up at the center from inside the sauna, insert the tongue of the panel into the groove of the other panel, and let them back down to their final position. Gently slide the ceiling panels so that the grooves in the ceiling panels line up with the grooves in the wall panels.

Ceiling Trim and Door Alignment

9. Fasten the 1" x 1" ceiling trim to the ceiling with the #6 x 2" screws. Align the door. The door is considered aligned when the spacing between the door and the door frame is equal on all sides. The door should open and close easily without rubbing on any side. Use a small slotted screw driver to adjust the roller catch in or out as needed. When satisfied with door, measure, cut, and install the front wall ceiling moldings to keep the door in place.

Bench Installation

10. Install 1 ½" x 2 ½" ledgers for benches with the 3" screws provided and be sure to level the ledgers. Refer to sketch for proper heights. The longer ledger is for the bottom bench(es) and the shorter ledger is for the upper bench(es). For L-Shaped benches, additional ledgers are provided, except for some cases where a window is involved. In those cases, the side bench ledger is replaced with a box leg support, which attaches to the side wall.

For benches longer than 6' 0", center leg supports are provided (see attached bench install sheet).

11. Set benches in place and secure to wall by driving 2 or 3 (3") screws through the end of each bench between the 2x2 boards. Use a #2 Phillips Head 3 ½" long extension bit to prevent damaging the bench tops.

Heater Installation and Final Steps

12. Install Sauna heater by referring to information in wiring diagram provided with heater. Remove the metal heater grill. Fill heater cavity with stones provided. Pack stones loosely between elements and on top until elements are covered. You may not need all of the stones provided.
13. Install heater fence around heater with the screws provided (see sketch for installation instructions and wiring guide for necessary clearances). Some models do not require a heater fence.
14. Install upper vent in cut out provided. The vent register (with louver that opens and closes) is typically placed on the inside of the Sauna room.
15. Install mat flooring (provided) in area between door and benches. **Note: The standard Superdek plastic mat flooring is only provided for the walking area of the Sauna, not the entire floor.
16. Hang thermometer 6" from ceiling directly above Sauna Heater, and hang bathing sign on exterior front wall. Warning signs (in heater box) should be placed near heater so that they are visible to sauna bathers.
17. Install exterior corner moldings and panel seam strips (provided for standard exterior). The 1 ½" x 1 ½" Outside Corner Moldings should be nailed to the exterior corners of prefab. The ¼" x 1" Seam moldings are used only on walls with Ruff-sawn Mahogany Exterior. The Seam strips should be nailed to the exterior side of the panels to cover the gap where the panels meet.
18. Seal entire door, inside & outside (except for glass), with multi purpose water sealer (e.g. Thompson's Waterseal, Olympic Water Guard), or contact your local paint store for what is recommended in your area.
19. Now you are ready for electrical wiring and hookup. This should be completed by a qualified electrician as per wiring instructions provided with heater. For ease in wiring, metal conduit is sealed within the wall sections for the heater, control or light switch (if needed), and the wall light. A Junction box is installed for the heater, light switch, and wall light. With standard electrical, wiring enters at the top of the Sauna. The Electrician should run wire over ceiling of Sauna and down through conduit located in front or side wall. For Outdoor Sauna with custom electrical see specific Outdoor Sauna instructions.



FINLANDIA SAUNA

FPF 810 Follow 27 easy steps

2"x4" BASE

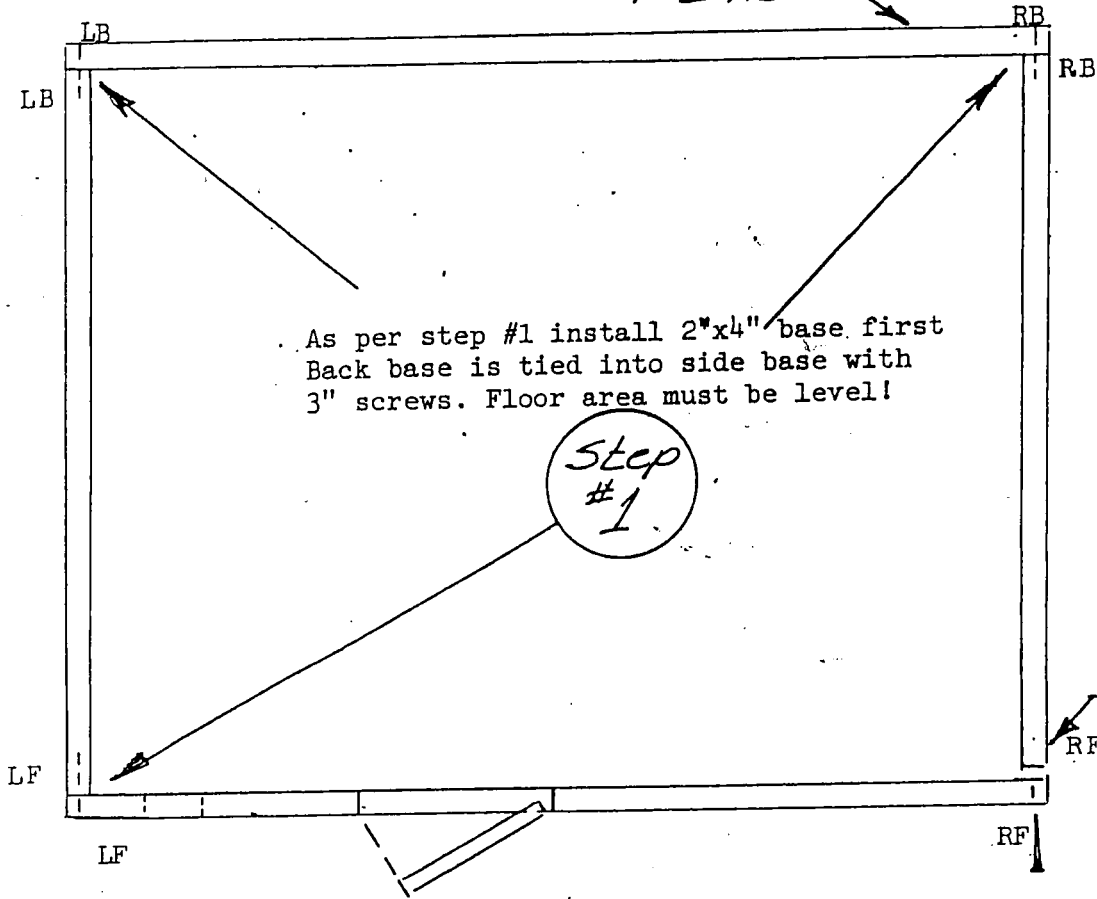

Leave right front open until last wall panel is inserted into base and panels FR and R5 are locked. Screw base FR and FR together.

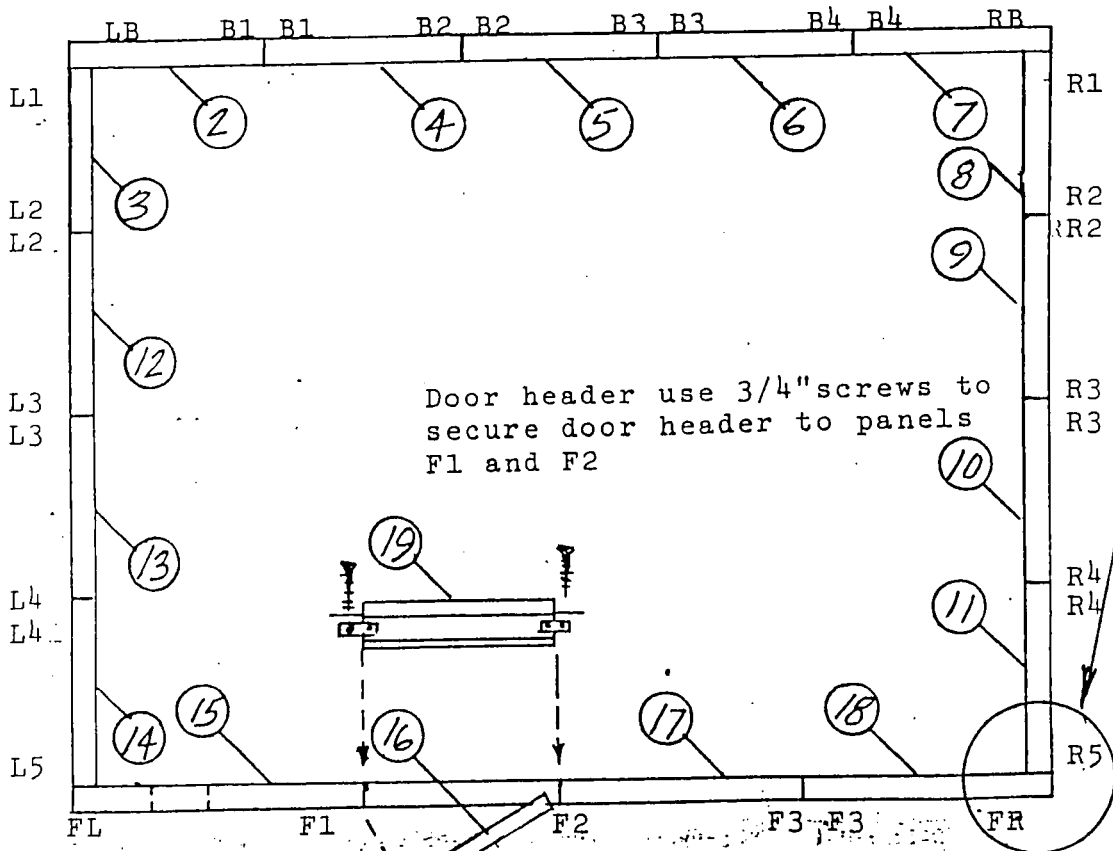

scale 1/2" = 1'-0"



FINLANDIA sauna

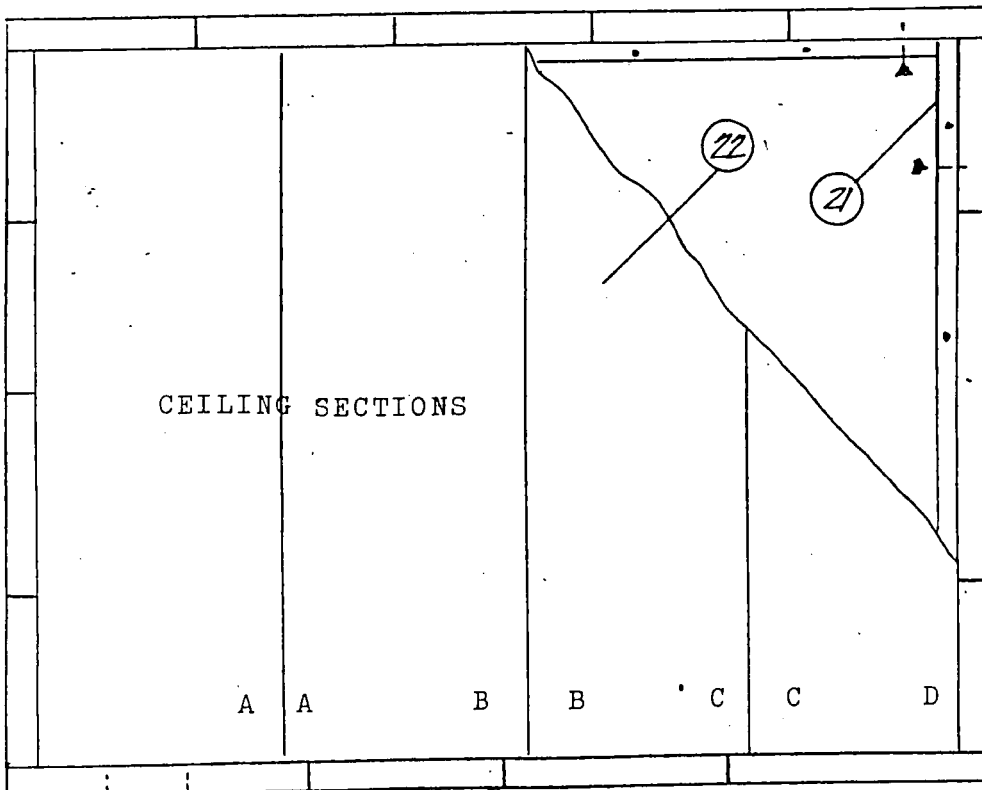
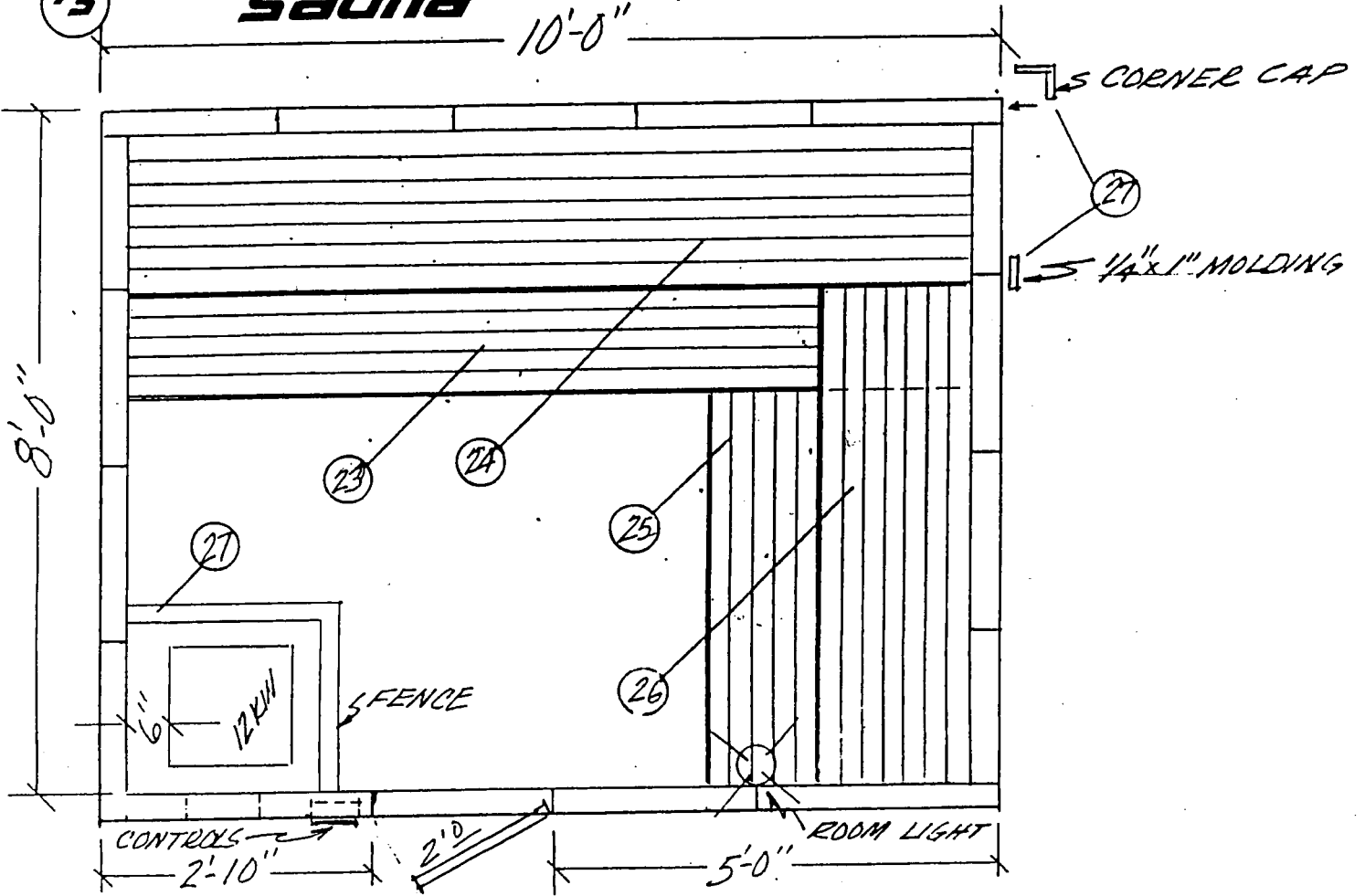

Scale 1/2" = 1'-0"

PREFAB CEILING INSTALLATION

After walls & door are in place, install ceiling. **Detail #1**--Screw 1"x1" molding into wall panels, making top of molding even with the top of the wall paneling. Moldings must be cut to proper size. Lift ceiling sections into place. **Detail #2**--If there's more than one ceiling section, line sections so ends are even & squeeze together so that T&G grooves meet tightly. **Detail #3**--Then screw wood screws through bottom of moldings to ceiling, to secure panels.

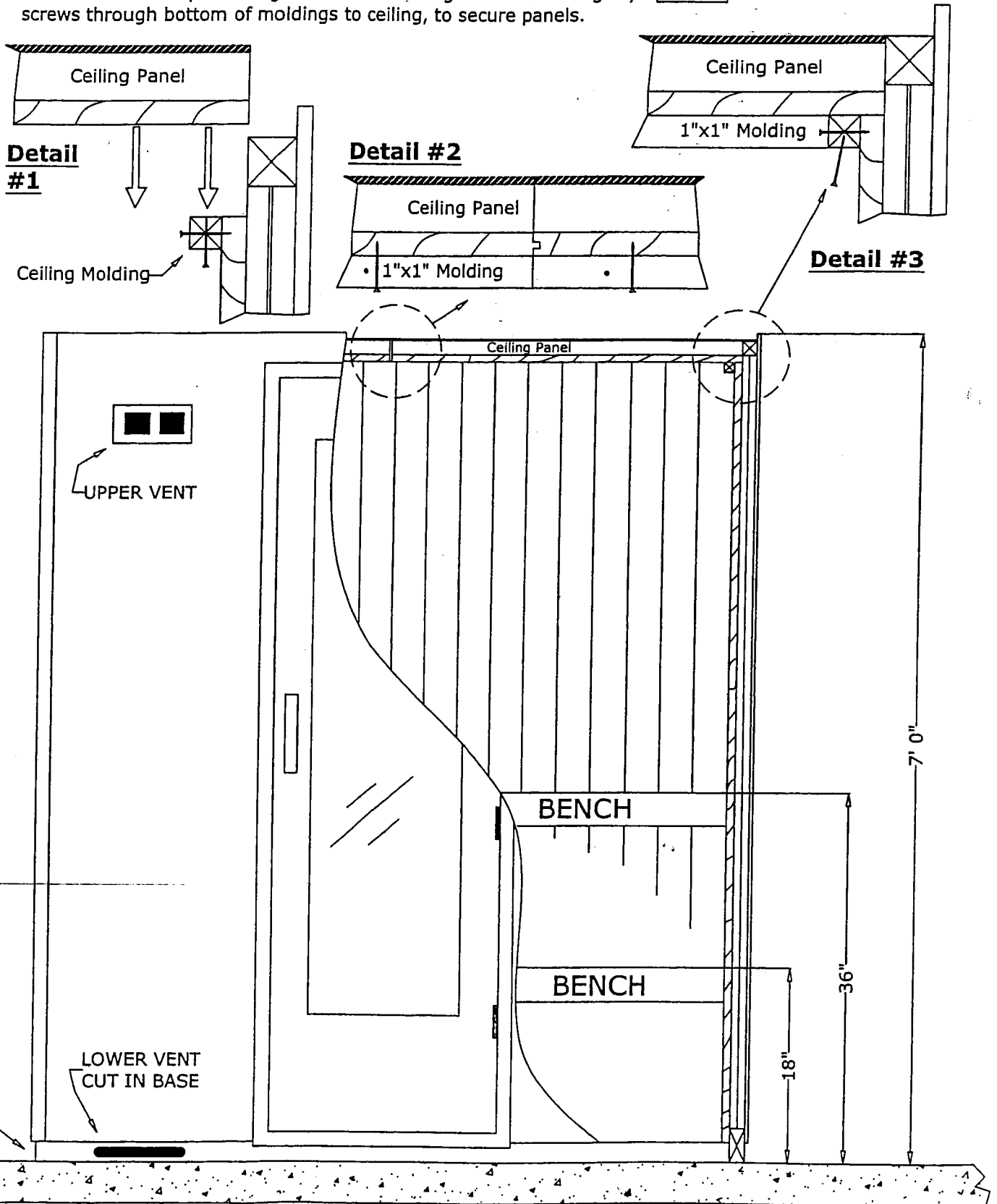

FPF BENCH LEDGERS

BENCHES LONGER THEN 6' MUST HAVE
A CENTER LEG; TWO LEGS IF 12' OR LONGER

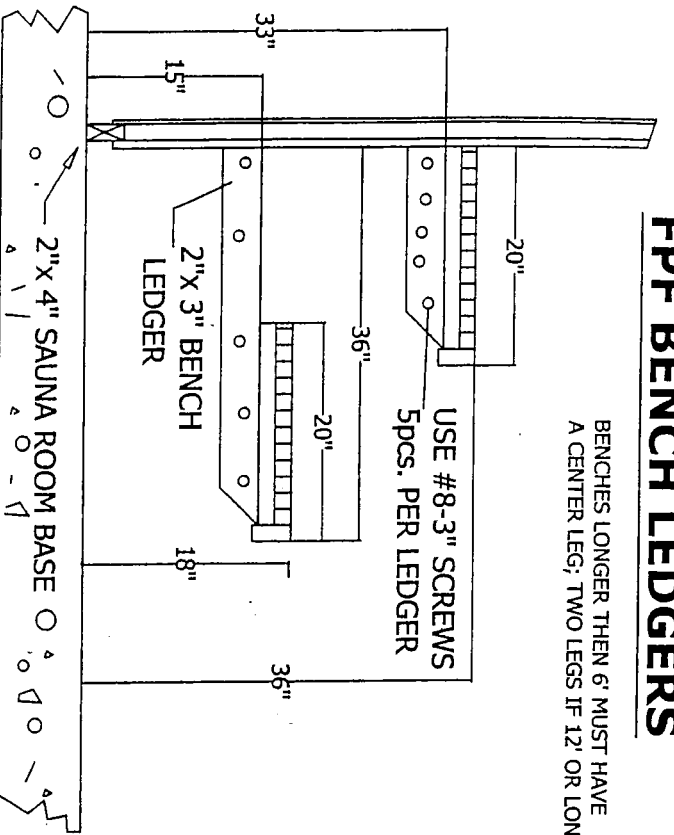

Standard ledger for upper benches is 18 1/2" long
Standard ledger for lower benches is 34 1/2" long

L BENCH CONNECTION

(Use if applicable)

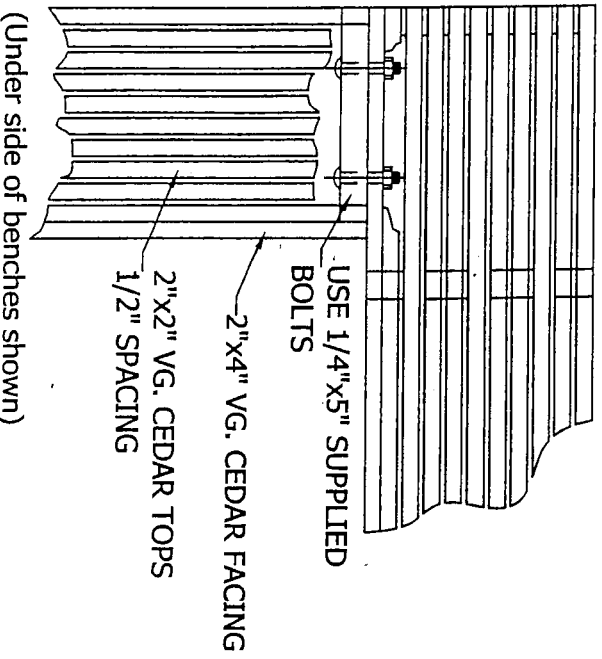

BENCH CENTER LEG DETAIL

(Use if applicable)

WHEN INSTALLING BENCH OVER 6' LONG YOU
MUST USE CENTER LEG MADE OF 2"X3"

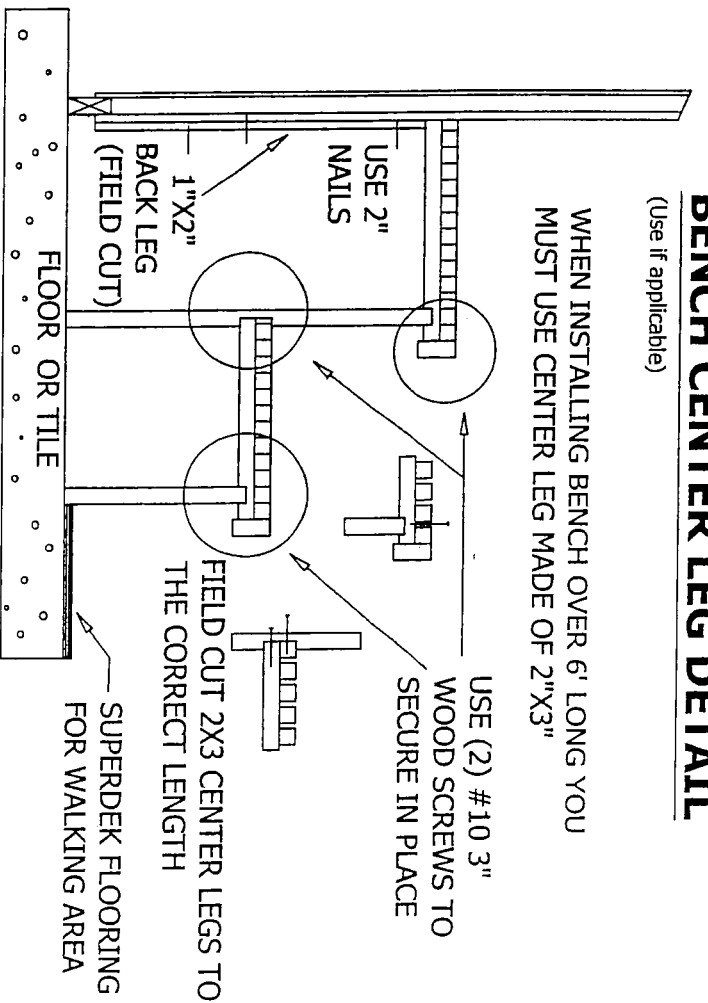

PIANO LEG

(Use if applicable)

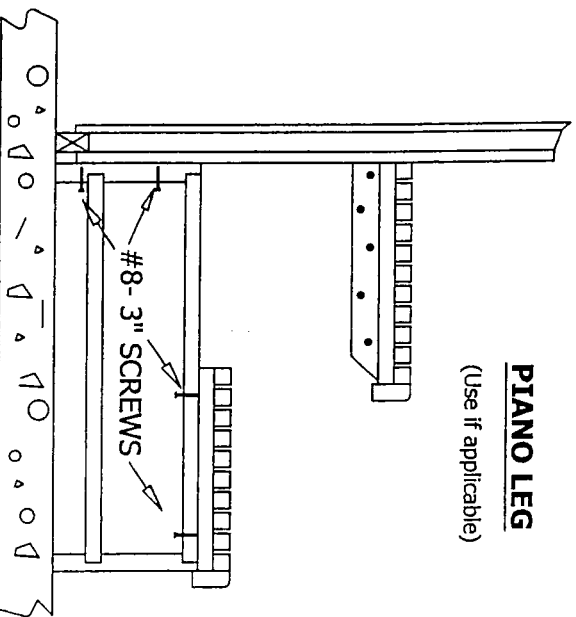

HEATER GUARD ASSEMBLY

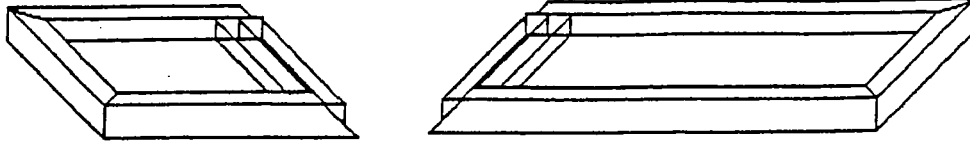

The heater guard comes in two pieces as shown above. The two 45 degree angled ends fit together to form a 90 degree angle. Use the screws provided to assemble the two pieces together. Fasten the heater guard to the wall as shown below with screws attached. The top of the heater guard should match up with the level of the heater casing.

